

FORM NO. 1.

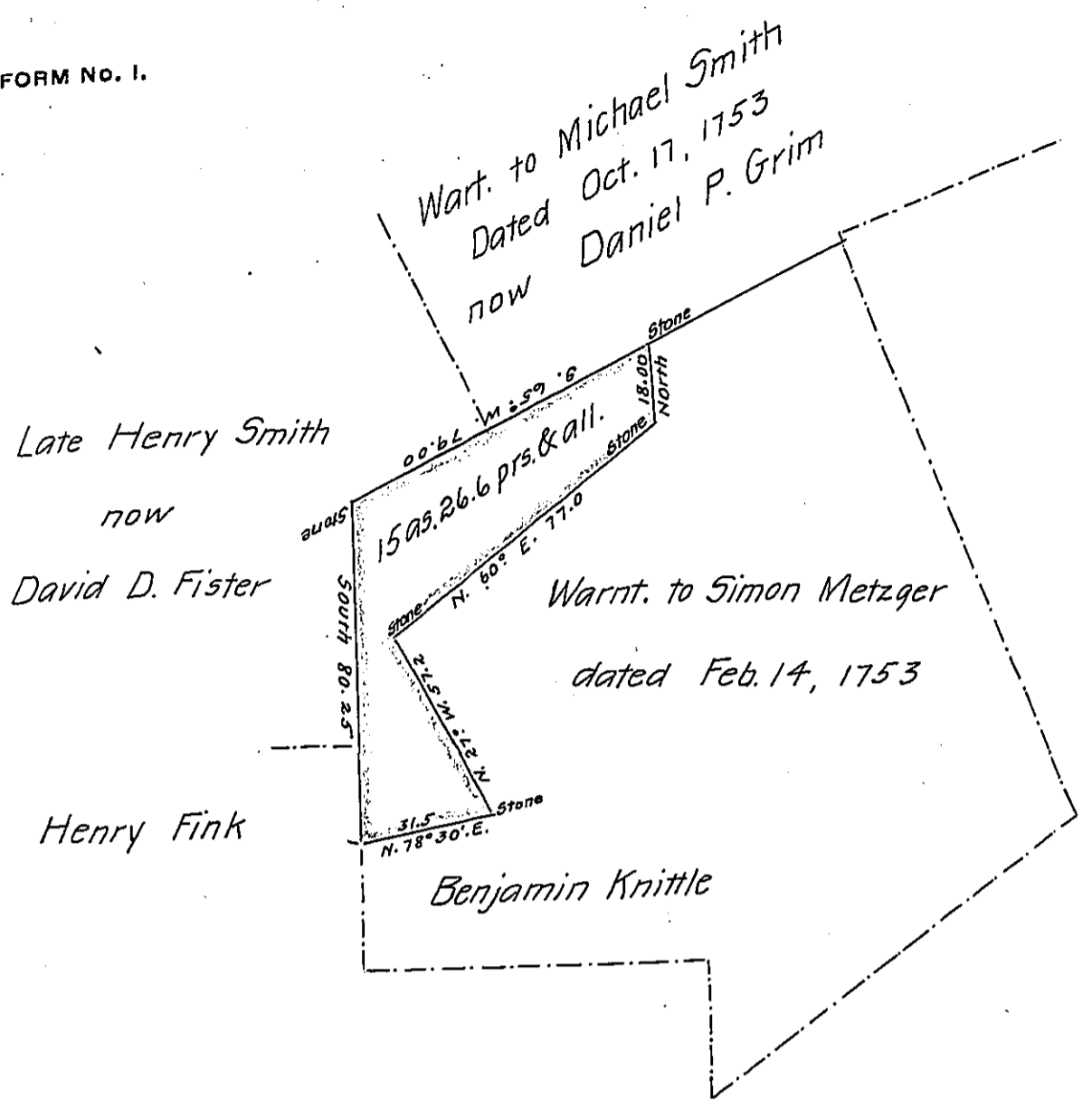

A draft of a tract of land situated in the township of Greenwich, and county of Berks, containing fifteen acres and twenty six perches and six tenths and allowance of six per cent. for roads, &c. Partly surveyed the 27th - May, 1884, for Daniel P. Grim, it being part of a larger tract of one hundred twenty eight acres forty perches and allowance, originally surveyed in pursuance of a warrant granted to Simon Metzger, dated February 14: 1753.

Sol. K. Dreibelbis C.S.

To J. Simpson Africa Esqr.  
Sec. of Int. Affairs.

IN TESTIMONY that the above is a copy of the original remaining on file in the Department of Internal Affairs of Pennsylvania, made conformably to an Act of Assembly approved the 16th day of February, 1833, I have hereunto set my Hand and caused the Seal of said Department to be affixed at Harrisburg, this fourteenth day of March 1906

*Loach D. Brown*  
Secretary of Internal Affairs.